



## De Warrene Court, Norfolk, IP26 4RT

Rent - Guide Price £250,000      Deposit -

TO BE SOLD BY MODERN METHOD OF AUCTION

A well presented modern detached 3 bedroom bungalow residence with garage pleasantly situated in a small cul-de-sac within the Norfolk village of Methwold. The property benefits from comfortable, contemporary accommodation throughout and an early viewing is recommended.

- CONSTRUCTED APPROXIMATELY 5 YEARS AGO
- EDGE OF VILLAGE
- LIVING ROOM/ KITCHEN
- THREE BEDROOMS PLUS EN-SUITE
- UNDERFLOOR AIR SOURCE HEATING
- MODERN DEVELOPMENT OF HOMES
- CONTEMPORARY FITTINGS THROUGHOUT
- SEPARATE UTILITY ROOM
- UPVC DOUBLE GLAZING
- GARAGE, EXTENSIVE PATIO & ENCLOSED GARDENS



Council Tax Band: D - EPC Rating: B 85

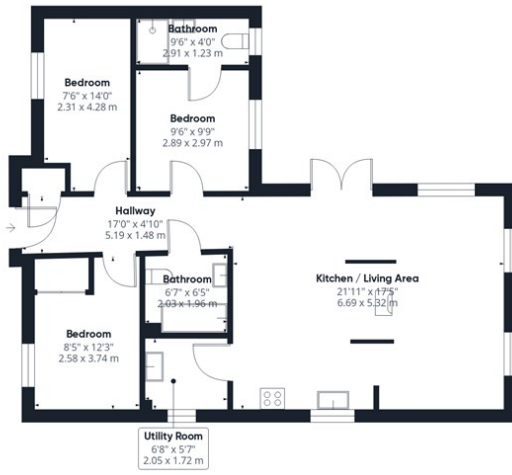

Ground Floor Building 1



Ground Floor Building 2

**Approximate total area<sup>(1)</sup>**  
 1129 ft<sup>2</sup>  
 104.8 m<sup>2</sup>

(1) Excluding balconies and terraces

Calculations reference the RICS IPMS 3C standard. Measurements are approximate and not to scale. This floor plan is intended for illustration only.

GIRAFFE 360

